

# LR-200-072 Quick Reference Card

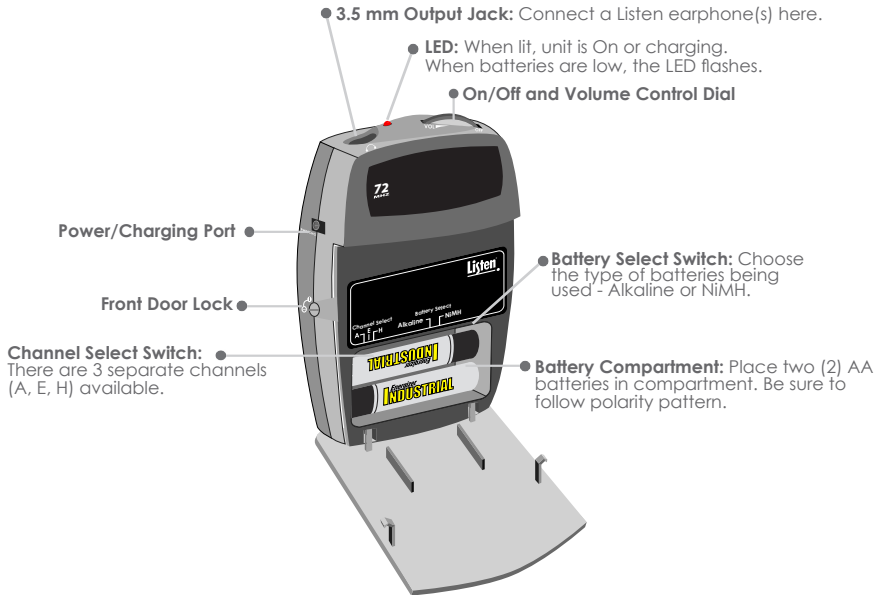

# LR-200-072 Quick Reference Card

---



## **Channel Selection**

- Slide the switch inside of front door to change channel. Designate channel A, E, H by moving switch to the left, center, or right. The channel on the LR-200 must match the channel on the transmitter for the system to function properly.

**IMPORTANT:** DO NOT ATTEMPT TO CHARGE ANY TYPE OF BATTERY OTHER THAN NiMH (NICKEL METAL HYDRIDE) with your Listen equipment. In order to charge NiMH batteries, the BATTERY SELECT switch in your Listen product must be set to the NiMH setting.

**WARNING:** When using a Listen charging case, the case lid **MUST** be open or removed while the units are charging.

For further details regarding advanced options for your Listen products please visit our website at [www.listentech.com](http://www.listentech.com) Resources/Support/Manuals or contact Listen at +1.801.233.8992 • +1.800.330.0891 North America